

Product datasheet

Mouse CD8 alpha ELISA Kit ab238264

Recombinant SimpleStep ELISA

★★★★☆ 1 Abreviews 5 Images

Overview

Product name Mouse CD8 alpha ELISA Kit

Detection method Colorimetric

Precision

Intra-assay

Sample	n	Mean	SD	CV%
Mouse thymus	8			8.8%

Inter-assay

Sample	n	Mean	SD	CV%
Mouse thymus	3			5.3%

Sample type Tissue Extracts

Assay type Sandwich (quantitative)

Sensitivity 46 pg/ml

Range 0.31 ng/ml - 20 ng/ml

Recovery

Sample specific recovery

Sample type	Average %	Range
Tissue Extracts	104	91% - 129%

Assay time 1h 30m

Assay duration One step assay

Species reactivity **Reacts with:** Mouse

Product overview

Mouse CD8 alpha ELISA Kit (ab238264) is a single-wash 90 min sandwich ELISA designed for the quantitative measurement of CD8 alpha protein in tissue extracts. It uses our proprietary SimpleStep ELISA® technology. Quantitate Mouse CD8 alpha with 46 pg/ml sensitivity.

SimpleStep ELISA® technology employs capture antibodies conjugated to an affinity tag that is recognized by the monoclonal antibody used to coat our SimpleStep ELISA® plates. This

approach to sandwich ELISA allows the formation of the antibody-analyte sandwich complex in a single step, significantly reducing assay time. See the SimpleStep ELISA® protocol summary in the image section for further details. Our SimpleStep ELISA® technology provides several benefits:

- Single-wash protocol reduces assay time to 90 minutes or less
- High sensitivity, specificity and reproducibility from superior antibodies
- Fully validated in biological samples
- 96-wells plate breakable into 12 x 8 wells strips

A 384-well SimpleStep ELISA® microplate ([ab203359](#)) is available to use as an alternative to the 96-well microplate provided with SimpleStep ELISA® kits.

Notes Abcam has not and does not intend to apply for the REACH Authorisation of customers' uses of products that contain European Authorisation list (Annex XIV) substances. It is the responsibility of our customers to check the necessity of application of REACH Authorisation, and any other relevant authorisations, for their intended uses.

Platform Pre-coated microplate (12 x 8 well strips)

Properties

Storage instructions Store at +4°C. Please refer to protocols.

Components	1 x 96 tests
10X Mouse CD8 alpha Capture Antibody	1 x 600µl
10X Mouse CD8 alpha Detector Antibody	1 x 600µl
10X Wash Buffer PT (ab206977)	1 x 20ml
50X Cell Extraction Enhancer Solution (ab193971)	1 x 1ml
5X Cell Extraction Buffer PTR (ab193970)	1 x 10ml
Antibody Diluent CPR2	1 x 6ml
Mouse CD8 alpha Lyophilized Recombinant Protein	2 vials
Plate Seals	1 unit
Sample Diluent NS (ab193972)	1 x 12ml
SimpleStep Pre-Coated 96-Well Microplate (ab206978)	1 unit
Stop Solution	1 x 12ml
TMB Development Solution	1 x 12ml

Function Identifies cytotoxic/suppressor T-cells that interact with MHC class I bearing targets. CD8 is thought to play a role in the process of T-cell mediated killing. CD8 alpha chains binds to class I

MHC molecules alpha-3 domains.

Involvement in disease

Defects in CD8A are a cause of familial CD8 deficiency (CD8 deficiency) [MIM:608957]. Familial CD8 deficiency is a novel autosomal recessive immunologic defect characterized by absence of CD8+ cells, leading to recurrent bacterial infections.

Sequence similarities

Contains 1 Ig-like V-type (immunoglobulin-like) domain.

Post-translational modifications

All of the five most carboxyl-terminal cysteines form inter-chain disulfide bonds in dimers and higher multimers, while the four N-terminal cysteines do not.

Cellular localization

Secreted and Cell membrane.

Images

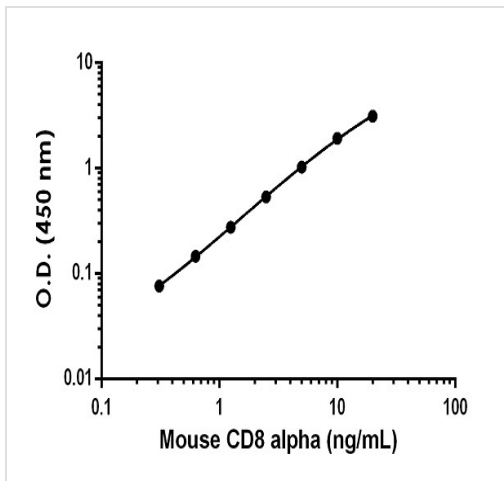

Background-subtracted data values (mean +/- SD) are graphed.

Example of mouse CD8 alpha standard curve in 1X Cell Extraction Buffer PTR.

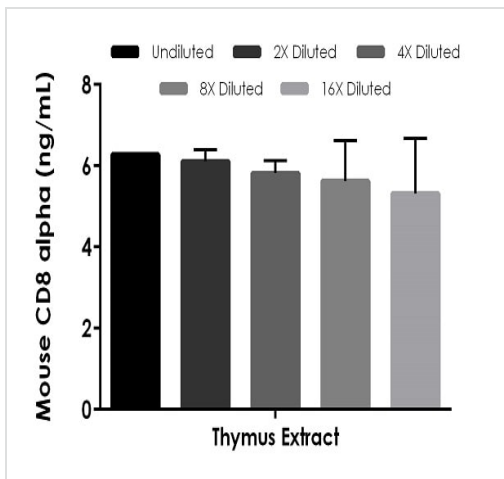

The concentrations of CD8 alpha were measured in duplicates, interpolated from the CD8 alpha standard curves and corrected for sample dilution. Undiluted samples are as follows: thymus 400 µg/mL. The interpolated dilution factor corrected values are plotted (mean +/- SD, n=2).

Interpolated concentrations of native CD8 alpha in mouse thymus extract samples.

Powered by
recombinant antibodies



Research with confidence
Consistent and reproducible results



Long-term and scalable supply
Recombinant technology



Success from the first experiment
Confirmed specificity



Ethical standards compliant
Animal-free production

Sandwich ELISA - Mouse CD8 alpha ELISA Kit
(ab238264)

To learn more about the advantages of recombinant antibodies see [here](#).

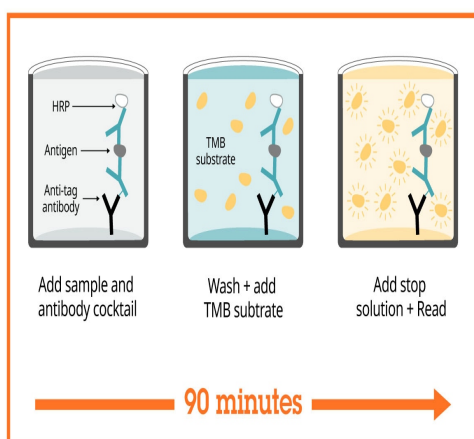

Sandwich ELISA - Mouse CD8 alpha ELISA Kit
(ab238264)

SimpleStep ELISA technology allows the formation of the antibody-antigen complex in one single step, reducing assay time to 90 minutes. Add samples or standards and antibody mix to wells all at once, incubate, wash, and add your final substrate. See protocol for a detailed step-by-step guide.

Get more done with SimpleStep ELISA



Easy to use
Single-wash 90-minute protocol



Flexible
Matched antibody pairs available



Precision antibodies
High sensitivity, specificity and reproducibility



Scalable
Now in 10-pack and 384-well formats

Sandwich ELISA - Mouse CD8 alpha ELISA Kit
(ab238264)

To learn more about the advantages of SimpleStep ELISA[®] kits see [here](#).

Please note: All products are "FOR RESEARCH USE ONLY. NOT FOR USE IN DIAGNOSTIC PROCEDURES"

Our Abpromise to you: Quality guaranteed and expert technical support

- Replacement or refund for products not performing as stated on the datasheet
- Valid for 12 months from date of delivery
- Response to your inquiry within 24 hours
- We provide support in Chinese, English, French, German, Japanese and Spanish
- Extensive multi-media technical resources to help you
- We investigate all quality concerns to ensure our products perform to the highest standards

If the product does not perform as described on this datasheet, we will offer a refund or replacement. For full details of the Abpromise, please visit <https://www.abcam.com/abpromise> or contact our technical team.

Terms and conditions

- Guarantee only valid for products bought direct from Abcam or one of our authorized distributors